

Product description	<b>RD30 female panel mount connector, Contacts: 12+PE, shielding is not possible, solder, IP65</b>
Area	<b>RD30 series 694</b>
Order number	<b>99 0720 00 13</b>

### Illustration

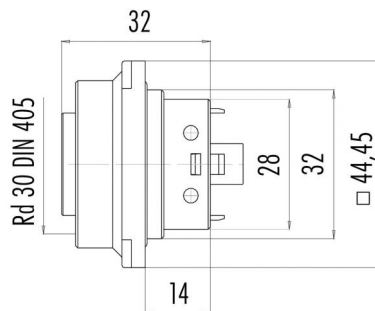

### Scale drawing



### Contact arrangement (Plug-in side)

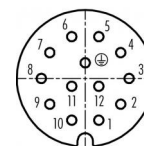

	X	Y
1	2,38	-7,33
2	6,23	-4,53
3	7,70	0,00
4	6,23	4,53
5	2,38	7,33
6	-2,38	7,33
7	-6,23	4,53
8	-7,70	0,00
9	-6,23	-4,53
10	-2,38	-7,33
11	-2,38	-1,37
12	2,38	-1,37
⊕	0,00	2,74

**You can find the assembly instructions on the next page.**

## Technical data

### General values

Connector design	female panel mount connector
Connector locking system	screw
Termination	solder
Wire gauge (mm)	max. 1.00 mm <sup>2</sup>
Wire gauge (AWG)	max. 17
Upper limit temperature	100 °C
Customs tariff number	85369010
Packaging Unit	20

### Electrical values

Rated current (40 °C)	6 A
Rated voltage	250 V
Rated impulse voltage	4000 V
Pollution degree	3
Overvoltage category	III
Insulating material group	III
Insulation resistance	≥ 10 <sup>10</sup> Ω
EMC compliance	shielding is not possible
Degree of protection	IP65
Mechanical operation	> 500 Mating cycles

### Material

Contact material	CuSn (bronze)
Contact plating	Ag (silver)
Contact body material	PA (UL94 HB)
Housing material	PA
REACH SVHC	CAS 7439-92-1 (Lead)

Product description **RD30 female panel mount connector, Contacts: 12+PE, shielding is not possible, solder, IP65**

Area **RD30 series 694**  
Order number **99 0720 00 13**

### Assembly instructions / Panel cut-out

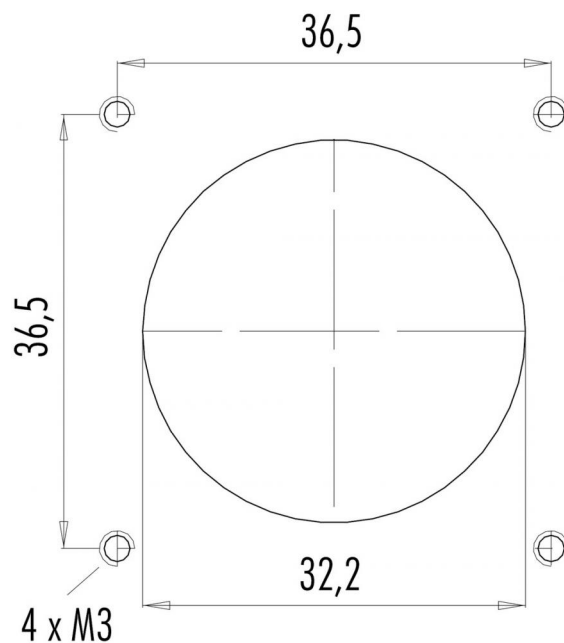

Product description	<b>RD30 female panel mount connector, Contacts: 12+PE, shielding is not possible, solder, IP65</b>
Area	<b>RD30 series 694</b>
Order number	<b>99 0720 00 13</b>

## Security notices

The connector must not be connected or separated under load. Non-observance and incorrect use can result in personal injury.

The connectors are designed for use in plant, control system and electrical equipment. The end user is responsible for checking whether the connectors are suitable for use in other applications.

Connectors with degree of protection IP 67 and IP 68 are not suitable for use under water. When used outdoors, the connectors must be separately protected against corrosion. For further information about IP degrees of protection refer to 'Technical support' in the Download Centre.